

# PHASE I MASTER PLAN

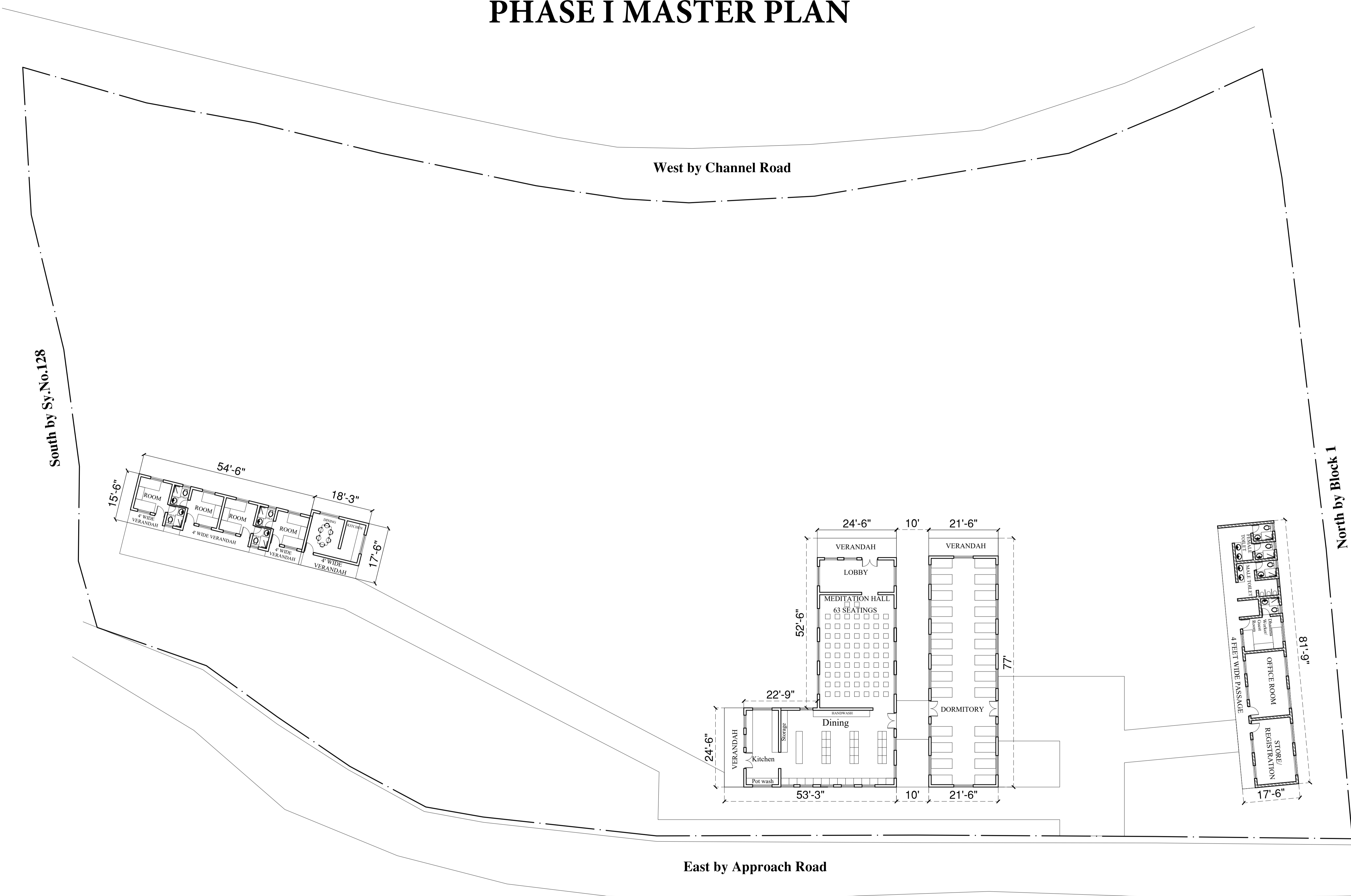

**JOB TITLE:**  
 PROPOSED MASTER PLAN FOR  
 VIPASSANA MEDITATION AND RESEARCH CENTRE,  
 at Sy.No. 129/13 , Kondajji Villagem Kasaba Hobli,  
 Harihara Taluk

AREA STATEMENT	
SITE AREA : 1 ACRE 33.08 GUNTA (79584 SFT)	79584 SFT
OFFICE BLOCK	1430.625 SFT
DORMITORY BLOCK	1655.50 SFT
MEDITATION BLOCK AND KITCHEN /DINING	2590.875 SFT
TEACHER'S QUATERS	1164.125 SFT
TOTAL BUILT-UP AREA	6841.125 SFT

**DRAWING NUMBER :** SD-01  
**DATE :** 25-07-2022  
**SCALE :** 1:400  
**NOTE:**  
 01.ALL DIMENSIONS ARE IN FEET AND  
 AREA IN SQUARE FEET ONLY UNLESS SPECIFIED.

**OWNER'S NAME AND SIGNATURE**  
 S.M.PRABUDEVIAH BIN S.M.CHANNABASIAH  
 (for SRI VIPASSANA MEDITATION RESEARCH  
 CENTRE TRUST)

**ENGINEER'S NAME AND SIGNATURE**